

Part. S0075

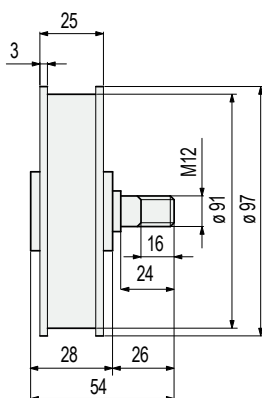

Winding tensioner



Load gr.	Winding travel mm	Direction of travel	Code
0+4000	2500	right	672642N
		left	672652N

- Noise reduction.
- * = Unwinding the spring, the load is almost constant 10/20% (loss of load).
- Material: pulley in reinforced polyamide PA FV (black), pin in brass.
- Packaging: 4 pieces.

Assembly of Part. S0075

